

STARBOND DETAIL APPLICATION

PREPARATION AND APPLICATION OF THE ROOF TO BE COATED WITH STARBOND METAL SHINGLE:

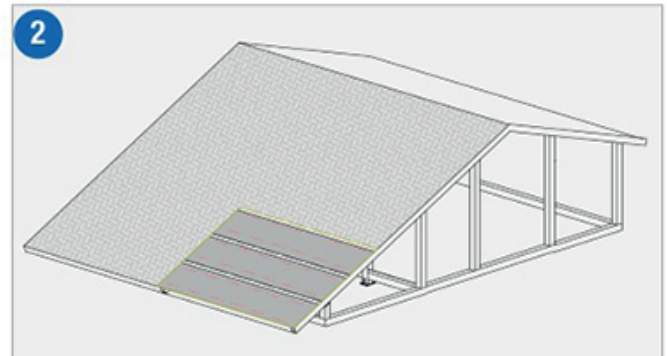

ON THE ROOF WHICH OSB COATING IS PERFORMED, MOISTURE AND VAPOR BALANCING STARBOND FLEX SOFT IS ASSEMBLED TO THE ROOF VIA BUNDLING SYSTEM.

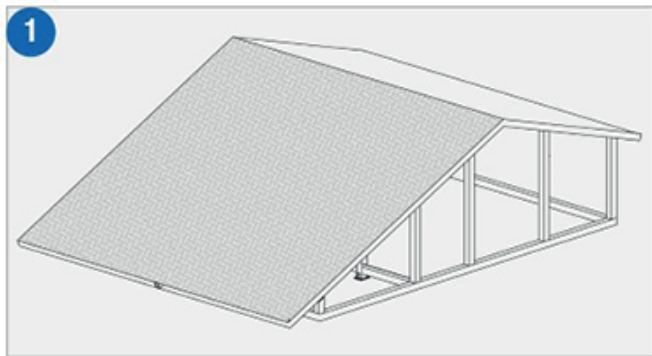
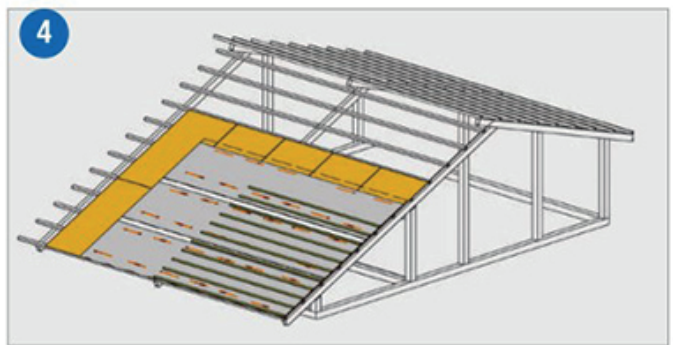
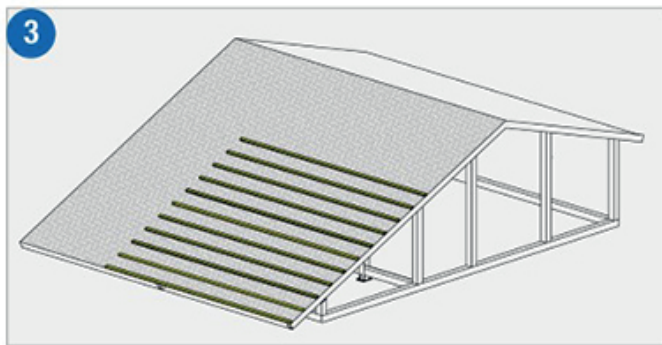

ON STARBOND FLEX SOFT, HORIZONTAL 50 X 50 mm WOODEN LATH IS NAILED 330 mm EXTERNALLY AND ASSEMBLED 370 mm INTERVAL BY CONSIDERING THE ROOF GUTTER.

IN THE ORDER STARBOND CLASSIC METAL SHINGLE 960 X 325 MM OR STARBOND ALATURKA METAL SHINGLE FORM IN 1040 X 325 MM SIZE, INJECTION PRINT UP TO 20 – 32 DENSITY, IN 50 MM THICKNESS STARBOND PAN POLYSTRENE FOAM IS COATED ON THE WOODEN ROOF OR TRAPEZ PANEL VIA INTERLOCK METHOD.

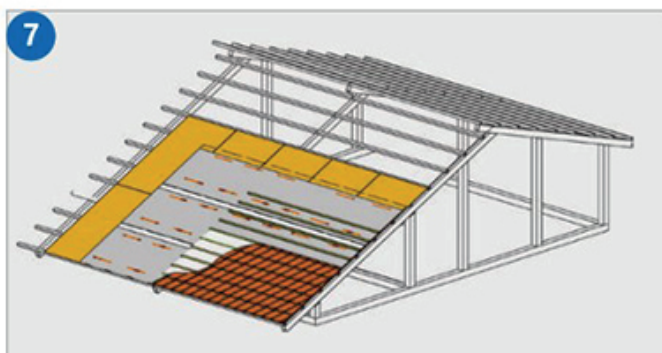
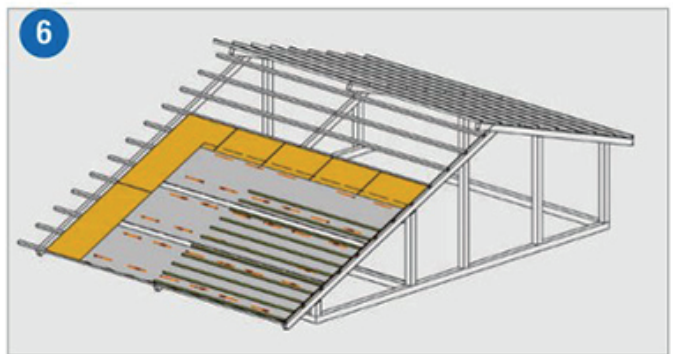
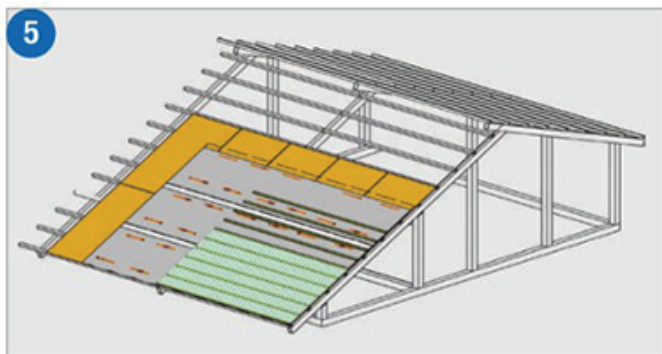

ON TOP OF IT THE SAME FORM OF STARBOND METAL SHINGLE PRODUCT IS ASSEMBLED HORIZONTALLY UNDER THE TRAPEZ OR WOODEN LOG VIA SCREWING

STARBOND ACCESSORIES APPLICATION

STARBOND METAL SHINGLE LATERAL FRINGE RIDGE, BASEBOARD RIDGE, TOP RIDGE AND VALLEY RIVER RIDGE IMPLEMENTATION :
WOODEN LOG OF 50 MM X 50 MM IS ASSEMBLED ON THE LATERAL RIDGE OF THE ROOF MATCHING ON THE HORIZONTAL RAFTERS, 50 MM HEIGHT OF RIDGE IS FORMED. THE STARBOND METAL SHINGLES COMING TO THE LATERAL FRINGE SHINGLE ARE BENT AND ASSEMBLED AS TO 50 MM TO THE DISTANCE AND 90 DEGREES TO THE RIDGE.

ON THE LATERAL EAVES PLATE, STARBOND LATERAL FRINGE RIDGE PROFILE IS APPLIED AS TO COVER FULLY OR PARTIALLY AGAIN WITH THE SAME LOGIC, THE STARBOND BASEBOARD PROFILE, STARBOND TOP RIDGE PROFILE IS APPLIED. ONLY IN STARBOND VALLEY RIVER PROFILE, WHEN WE COME TO RIGH AND LEFT FROM THE VALLEY CENTER IN 95 MM LATERALLY 50X50 MM WOODEN LATH IS VERTICALLY ASSEMBLED AND STARBOND VALLEY RIVER PROFILE IS SETTLED BETWEEN THE TWO ASSEMBLED LATHS AND THE EDGE OF THE STARBOND METAL SHINGLE MATCHING THE VALLEY RIVER IS CUT AS TO EXCEED IN 30 MM AND BENT INSIDE THE VALLEY RIVER AND ASSEMBLED VIA STARBOND METAL SHINGLE NAIL..

STARBOND TOP RIDGE PROFILE APPLICATION

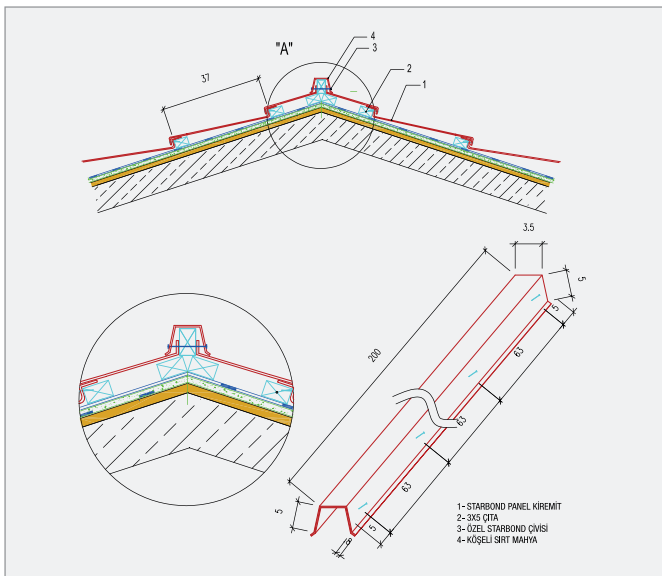

WOODEN LOG IS ASSEMBLED TO THE RIDGE OF THE ROOF AS 30 MM 50 MM VERTICALLY. THE STARBOND METAL SHINGLE ASSEMBLED TO THE RIDGE IS CUT AS DETERMINED SIZE AND BENT AS TO COVER THE WOODEN LOG AND TWISTED. THE STARBOND TOP RIDGE PROFILE ASSEMBLY IS APPLIED LATERALLY VIA SCREWING AND NAILING SYSTEM.

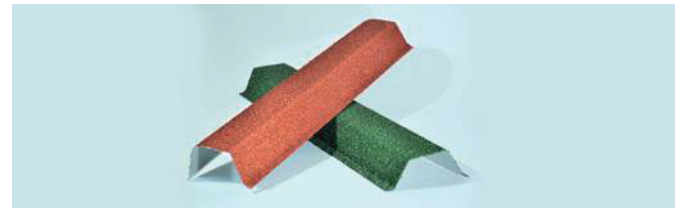

STARBOND RIDER PLATE PROFILE APPLICATION

STARBOARD RIDER PLATE PROFILE OF WHICH OSB WAS APPLIED AND 2 CM OF DROPPER IS BENT TO THE FORE RIDER IS ASSEMBLED AS 3 CM ON TO EACH OTHER.

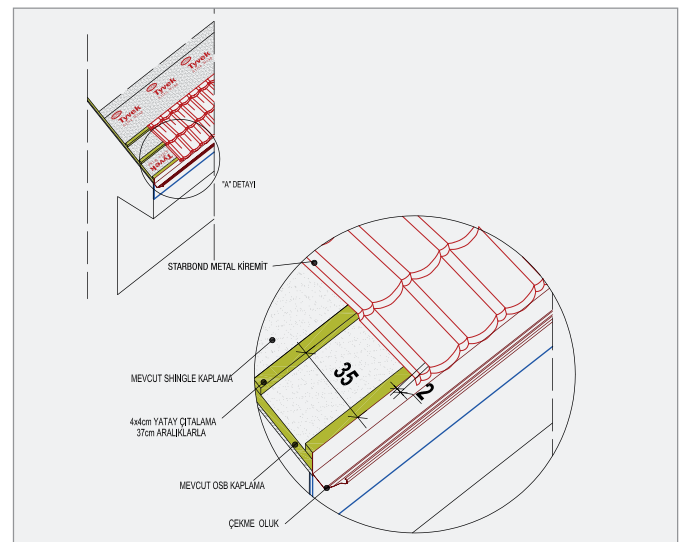
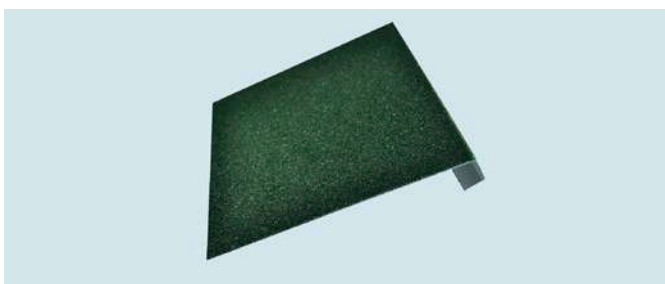

STARBOND BASEBOARD AND BACK CHIMNEY DETAIL

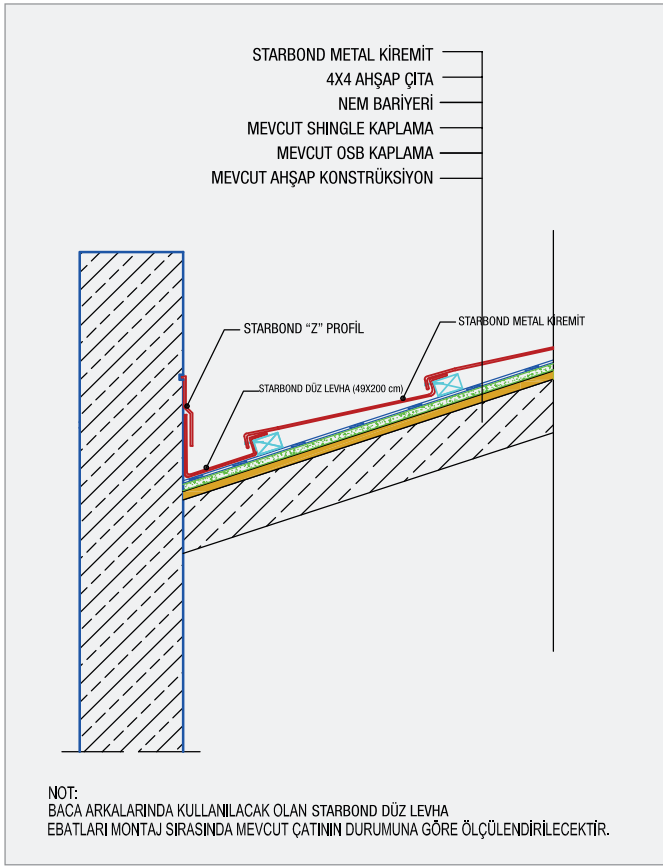

STARBOND VALLEY RIVER PROFILE APPLICATION

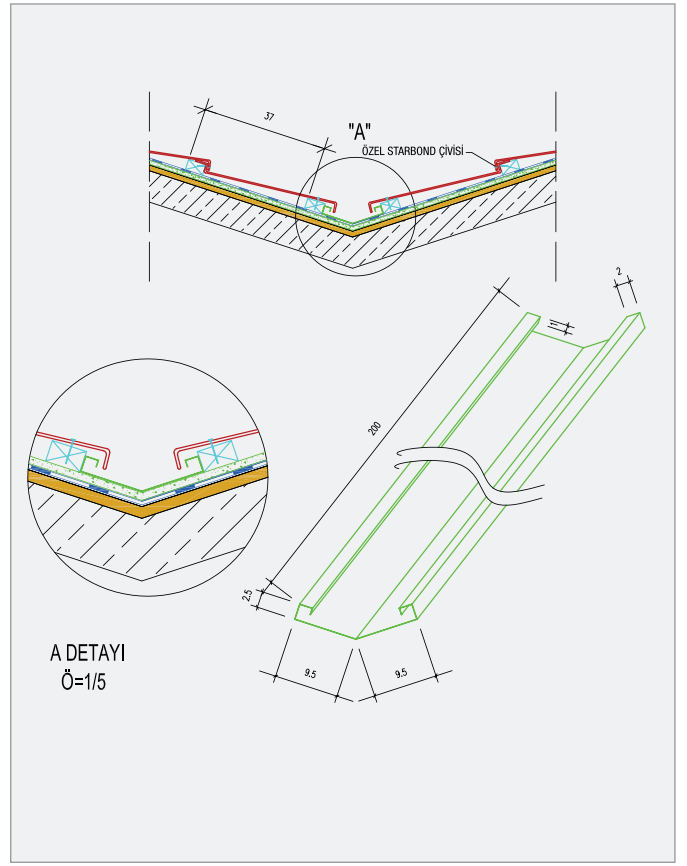

STARBOND LATERAL FRINGE RIDGE APPLICATION

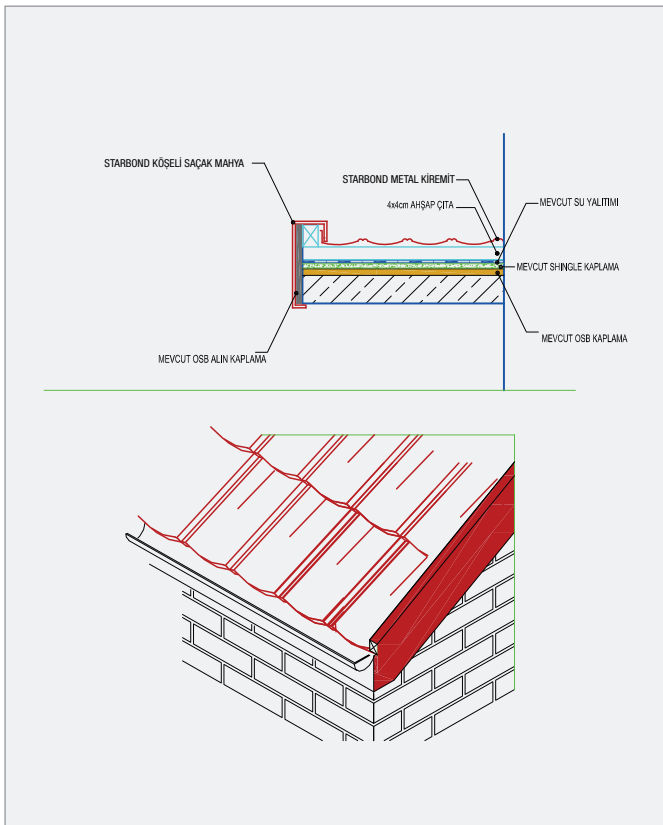

STARBOND FRONT FRINGE ASSEMBLY

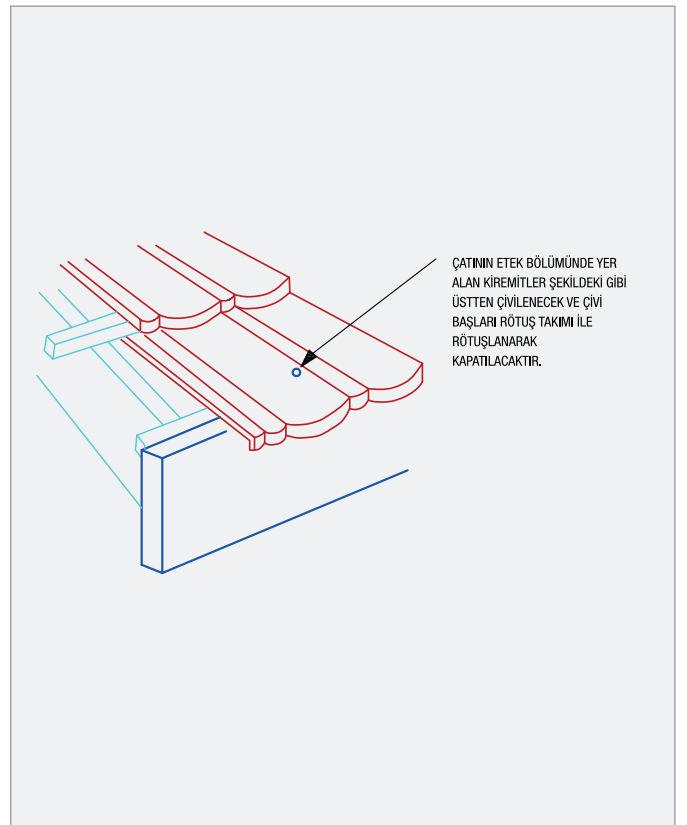

STARBOND TOP RIDGE PROFILE APPLICATION

THE SURFACE COVERED WITH RIDER WOOD AND RIDER PLATE IS ASSEMBLED INTERNALLY WITH CLAMPS BY GIVING A 2 DEGREES OF TILT.

ROUND RIDGE PROFILE APPLICATION

STARBOND ROUND RIDGE PROFILE APPLICATION ;

2 PCS OF VERTICAL WOODEN LOGS OF 5 CM X 10 CM ARE ASSEMBLED TO THE RIDGE. STARBOND METAL SHINGLE IS CUT ON THE ASSEMBLED WOODEN LOG IN THE SAME SIZE AND BENDING AND TWISTING IS MADE. STARBOND ROUND TABLE RIDGE PROFILE ASSEMBLE IS APPLIED VIA SCREWING AD NAILING SYSTEM.

VENTILATION SHINGLE PROFILE APPLICATION

STARBOND VENTILATION SHINGLE APPLICATION:

IT IS USED FOR VENTILATION OF THE ROOF OR INTEGRATION OF THE ROOF BY ASSEMBLING TO THE VENTILATION PIPE.

POINTS TO CONSIDER

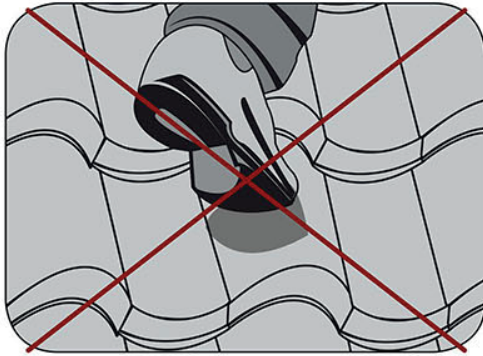

No

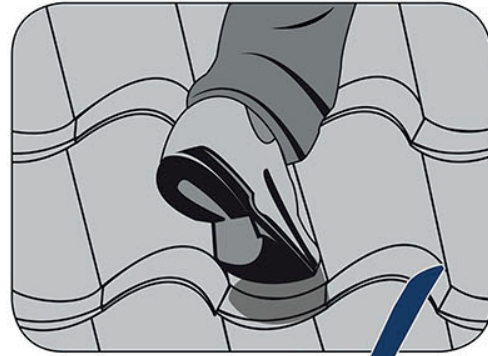

Yes

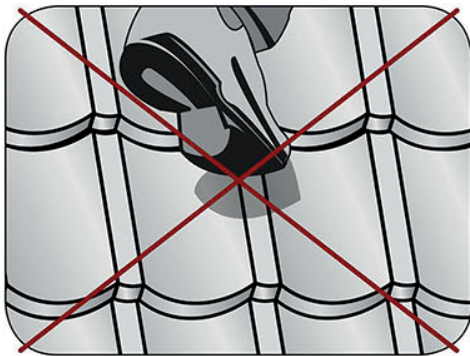

No



Yes

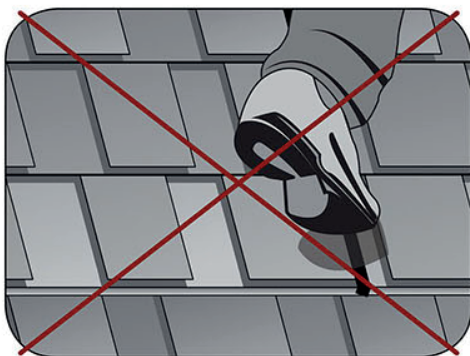

No



Yes